



Reeds Rains  
Sole Agents  
SOLD

VICTORIA  
MANSIONS

**Victoria Mansions 187-191 Newton Drive,**

Blackpool

Offers Over **£140,000**



## Victoria Mansions 187-191 Newton Drive, Blackpool

Situated in a desirable location close to Blackpool Victoria Hospital, this 1 Bedroom Ground Floor Flat is ideal for an investment opportunity, first time buy or those looking to downsize. Boasting a well-designed layout, the property features a welcoming hallway leading to a bright lounge with patio doors that open up to a delightful terrace, perfect for relaxing or entertaining. The flat also comprises a fitted kitchen, a comfortable bedroom, and a sleek bathroom. Residents can enjoy the convenience of communal gardens and allocated parking space, adding to the appeal of this property for potential buyers seeking a hassle-free property in a prime location.

Council Tax band: A

Tenure: Leasehold

- Investment Opportunity or ideal First Time Buy or for those looking to Downsize
- Ground Floor Flat
- Hallway, Lounge with patio doors opening up to Terrace, Kitchen, Bedroom, Bathroom
- Communal Gardens, Allocated Parking
- Close Proximity to Blackpool Victoria Hospital





**Hallway**  
3' 6" x 7' 4" (1.07m x 2.23m)

**Lounge**  
14' 0" x 13' 1" (4.27m x 3.99m)

**Kitchen**  
10' 8" x 8' 6" (3.25m x 2.59m)

**Bedroom**  
11' 8" x 14' 3" (3.56m x 4.34m)

**Bathroom**  
8' 6" x 6' 6" (2.58m x 1.97m)







**COMMUNAL GARDEN**

**ALLOCATED PARKING**

1 Parking Space

Private car park for residents.



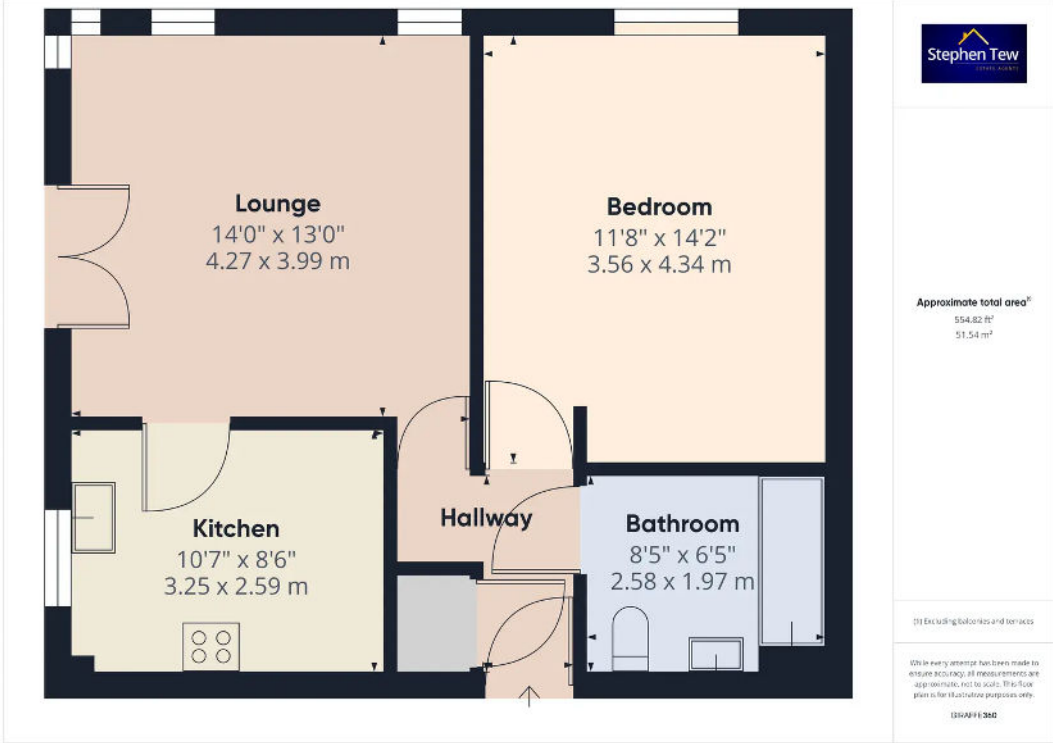





## Stephen Tew Estate Agents

Stephen Tew Estate Agents, 132 Highfield Road - FY4 2HH

01253 401111

[info@stephentew.co.uk](mailto:info@stephentew.co.uk)

[www.stephentew.co.uk](http://www.stephentew.co.uk)

